

Documentation Guide

MigrationPro: PrestaShop Upgrade and
Migrate Module



Superhero
Seller



Modules
Partner Creator



PrestaShop's
Favorite



+5000
downloads

Getting started

Phase 1.	Overview	3
Phase 2.	Preparation for migration	4
	Attentions	4
	Setup Target shop	4
	Download and Install Migration module	4
Phase 3.	Start migration process	5
	Source and Target shop connection	5
	Configuration	6
	Migration process	10
	Reporting	11
Phase 4.	Support	12



Overview

1

MigrationPro: Prestashop Upgrade and Migrate module helps you migrate and upgrade current Source shop to the latest version safely, quickly and efficiently just in one click. Additionally, for saving time and minimize efforts for merchants, with All-in-one service we'll perform data migration and provide all the necessary migration & customization for you. As an important part of the module implementation process, we are proud of our class 360° tech support and customer service, where you'll get professional care.

Features

- 1-Click Upgrade
- Data secure-safe migration
- Keep SEO ranking
- Passwords data saving
- 100% Uptime for Source store
- Migrate online or offline
- Multi-shop migration
- 24/7 class support
- Money-back guarantee

Take Advantage of 1-Click Upgrade

1-Click Upgrade gives you an opportunity to start migration instantly by default settings or you can go to advanced settings.

How it works

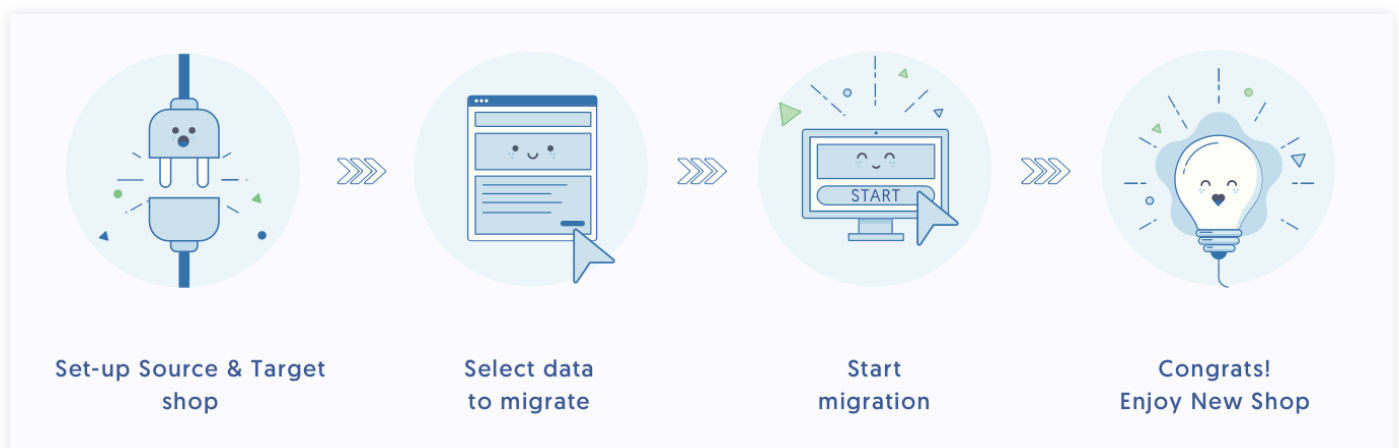



Preparation for migration

2

ATTENTION

Apply these options before migration

For Source shop:

- Ensure you have the right permission to upload module files into your Source shop.
It must not block access from Target shop to the connector file.
- Source shop can operate normally during migration as it requires a very limited resource for the process.

For Target shop (new shop):

- Target shop should be placed in a stable hosting or in localhost.
- PHP Curl must be enabled.
- PHP Fopen (allow_url_fopen) must be On.
- It also must not block connection to Source shop.
- Web server (mostly apache) should have full permission to write on /img folder.
- Demo mode on backend should be turned off
- base64_decode should be allowed.
- It is strongly recommended to backup Source and Target shop.

Setup Target shop (new shop)

For migrating data from Source shop you need to create a Target shop (new shop), where migrated data will be placed and saved.

Download and Install Migration module

- a. After downloading **migrationpro.zip** module file from PrestaShop Addons Marketplace, install the module to Target shop.
- b. Login Target shop backend, go to Modules Manager (if old version: "Modules and Services") and find "MigrationPro: PrestaShop Upgrade and Migrate tool Module".
- c. Click configure button on module.



Start migration process

3

Source and Target shop connection

To migrate Source data you need to establish a secure connection between Target and Source shop.

Download and install the bridge connector module to Source shop. Please make sure you are installing bridge connector module to the Source shop.

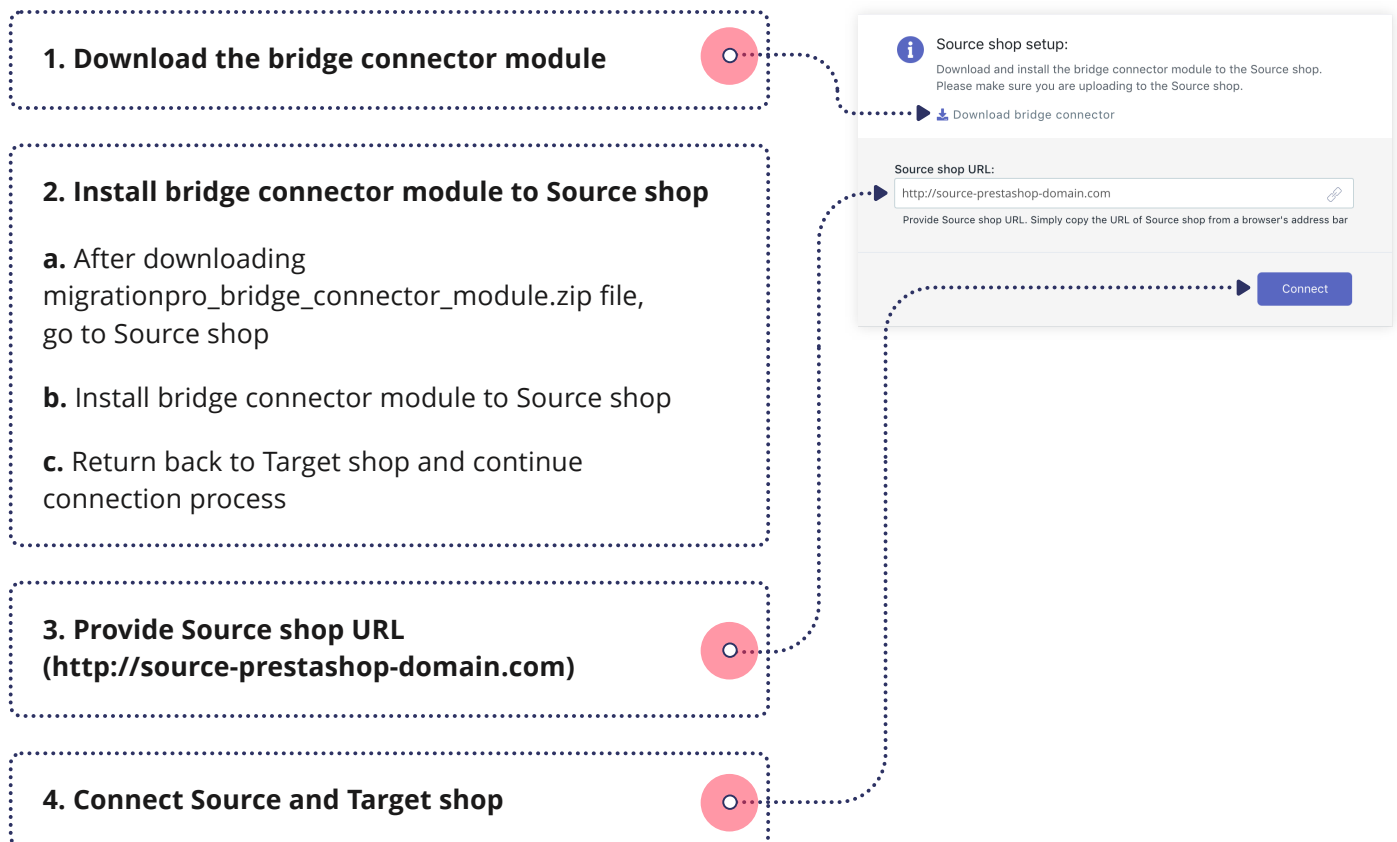

Configuration

Select entities and map Source shop data to start automated migration process. 1-Click Upgrade gives an opportunity to start migration instantly by default settings or go to advanced settings.

Find out modes of configuration

- * 1-Click Upgrade
- * Advanced Settings

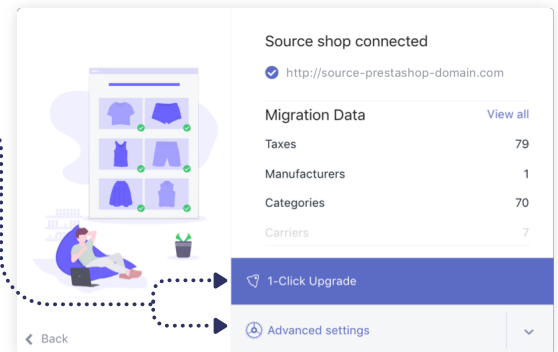

1-Click Upgrade

This is an automated migration process.

This setting arranges entities selection and mapping data by default and migrates data to Target shop similarly to Source shop.

Additional options in this configuration are being selected by default.

After getting informed by default settings, click '1-Click Upgrade' for confirmation.

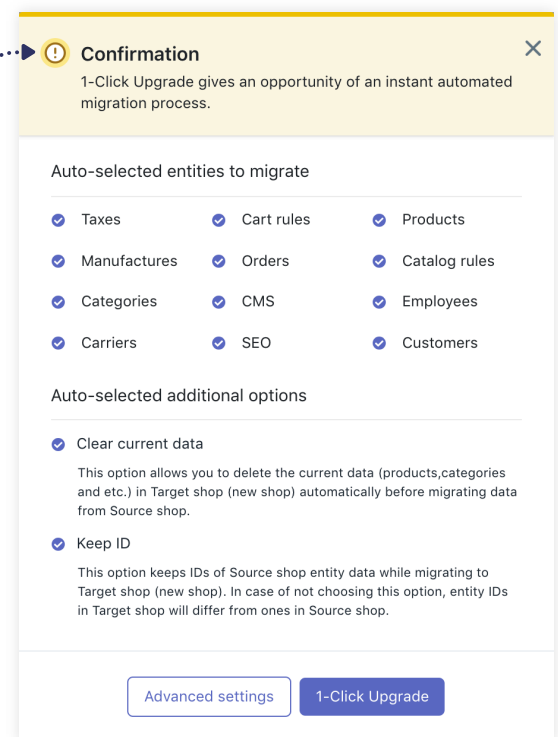

Consider

Consider that 'clear current data' option in this mode is selected by default. This is most applicable for you if there is no data (entities: products, customers, catalogs and etc) created in the Target shop (new shop). If data in the Target shop must not be deleted, go to advanced settings and select additional options.

Entity to migrate

Select entities to migrate to Target shop.

Additional options

Select options according to configuration.

Store mapping

Map shop data according to shop quantity and migration plan. If you want to migrate Source shop as multistore, set the Target shop as multistore, because it must be set a proper connection between entities in database.

Note: [Multistore creating & enabling explanation at page 9.](#)

Currency mapping

Assign Source shop currencies to proper Target shop currencies. Creating currencies in Target shop may be needed.

Language mapping

If Source shop is multilingual, corresponding languages should be available in Target shop. You may need to create additional languages in Target shop to avoid data loss.

Entities to migrate

☐ Select All

☐ Taxes

☒ Manufactures

☒ Categories

☐ Carriers

☐ Cart rules

☒ Orders

☐ CMS

☐ SEO

☒ Products

☐ Catalog price rules

☒ Employees

☒ Customers

Additional options

☒ Keep ID

This option keeps IDs of Source shop entity data while migrating to Target shop (new shop). In case of not choosing this option, entity IDs in Target shop will differ from ones in Source shop.

☐ Recent data migration

You have new entities on your Source shop (old shop) and you want to make migration again to Target shop (new shop) by keeping entities migration process in order and by not duplicating data. By this option, your recent data (products, customers, orders) will be migrated from your Source shop to Target shop.

☒ Clear current data

This option allows you to delete the current data (products, categories and etc.) in Target shop (new shop) automatically before migrating data from Source shop.

Mapping multistores

Source shop 1

Target shop 1

Source shop 2

Target shop 2

Source shop 3

Target shop 3

Mapping currencies

Euro

Euro

US Dollar

US Dollar

Mapping languages

Français (French)

Français (French)

Deutsch (German)

Deutsch (German)

English (English)

English (English)

Customer group mapping

Assign Source shop customer group to proper Target shop customer group. Creating additional customer group in Target shop may be needed.

Order status mapping

Assign Source shop order statuses to proper Target shop order statuses. Creating additional order statuses in Target shop may be needed.

Migration speed

Adjust speed according to your server performance.

Start migration

Click start migration after advanced settings configuration and confirm your action in pop-up page.

Mapping customer groups

Visitante

Visitor

Invitado

Guest

Cliente

Customer

Mapping order statuses

Payment accepted

Payment accepted

Processing in progress

Processing in progress

Shipped

Shipped

Delivered

Delivered

Canceled

Canceled

Refunded

Refunded

Delivery in progress

Delivery in progress

Handling of shipment in progress

Handling of shipment in progress

Stripe Partial Refund

Stripe Partial Refund

Migration speed

Item count per request

5 10 20 30 40 50 60 70 80 90 100

low medium high

Select slow migration count, if your shop(s) hosted on shared hosting or your server return error page 'internal server error'.

Back

Start migration

Advanced settings

Confirmation pop-up page will appear after clicking start migration. Read and check selected entities and additional options.

Confirmation

Selected entities to migrate

<input type="radio"/> Taxes	<input type="radio"/> Cart rules	<input checked="" type="checkbox"/> Products
<input checked="" type="checkbox"/> Manufactures	<input checked="" type="checkbox"/> Orders	<input type="radio"/> Catalog rules
<input checked="" type="checkbox"/> Categories	<input type="radio"/> CMS	<input checked="" type="checkbox"/> Employees
<input type="radio"/> Carriers	<input type="radio"/> SEO	<input checked="" type="checkbox"/> Customers

Selected additional options

☒ Clear current data

This option allows you to delete the current data (products, categories and etc.) in Target shop (new shop) automatically before migrating data from Source shop.

☒ Keep ID

This option keeps IDs of Source shop entity data while migrating to Target shop (new shop). In case of not choosing this option, entity IDs in Target shop will differ from ones in Source shop.

[Advanced settings](#) [Start migration](#)

Note:

Multistore settings guide in Target shop

1. Go to general

2. Enable multistores

3. Go to multistore

4. Add a new shop

PrestaShop 1.7.6.0 Quick Access

Preferences

General **Maintenance**

Allow customers to change the product description. We recommend that you leave this option disabled.

Use HTML Purifier Library

Clear cache

Round mode

Round up away from zero, when it is half way there (recommended)

Round type

Round up away from zero, when it is half way there (recommended)

Number of decimals

2

Display brands and suppliers

Display best sellers

Enable Multistore

Main Shop Activity

...

Multistore

Multistore Tree

Multistore

Shop group

Default

Multistore options

Default shop

Shop group

...

Migration process

Data is being migrated automatically according to selected entities and mapped Source shop data.

In order to progress, you should not remove migrationpro_bridge_connector_module.zip file from Source shop.

Migration process controller

You can play, pause or stop migration process at any time.

Migration period

Migration time being calculated approximately according to speed of entities' amount migration and server performance.

Progress bar

The progress bar shows percentage of migrated data for each entity.

Migration status

You can be aware about process status according status signs.

- ✓ Done status
- ⏸ Process paused status
- ✗ Error status

Stopping of migration

By stopping migration, the migration process will be lost and you need to start new migration from scratch.

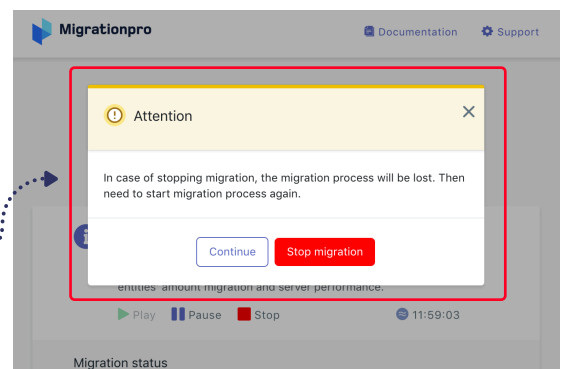
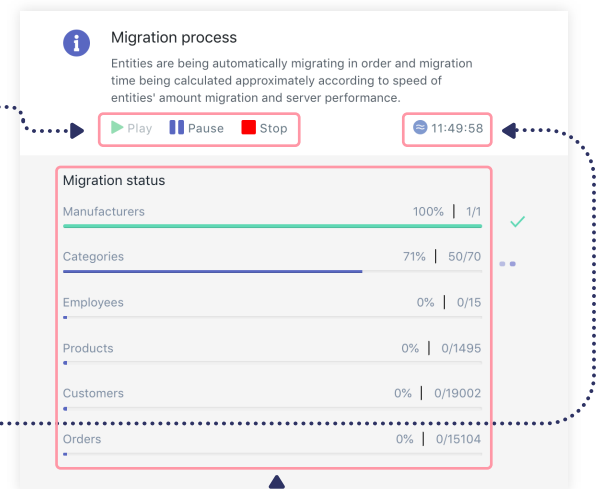

Reporting

After process completion, go through the report and check your new shop.

Due to PrestaShop thumbnail settings, some images may not be visible. According to PrestaShop validation guideline, our module can't execute to thumbnail settings.

After migration completion, we recommend to clear cache and re-build indexes. For doing that please apply these steps : "Advanced Parameters => Performance => Clear Cache" and "Preferences => Search => Re-build the entire index"

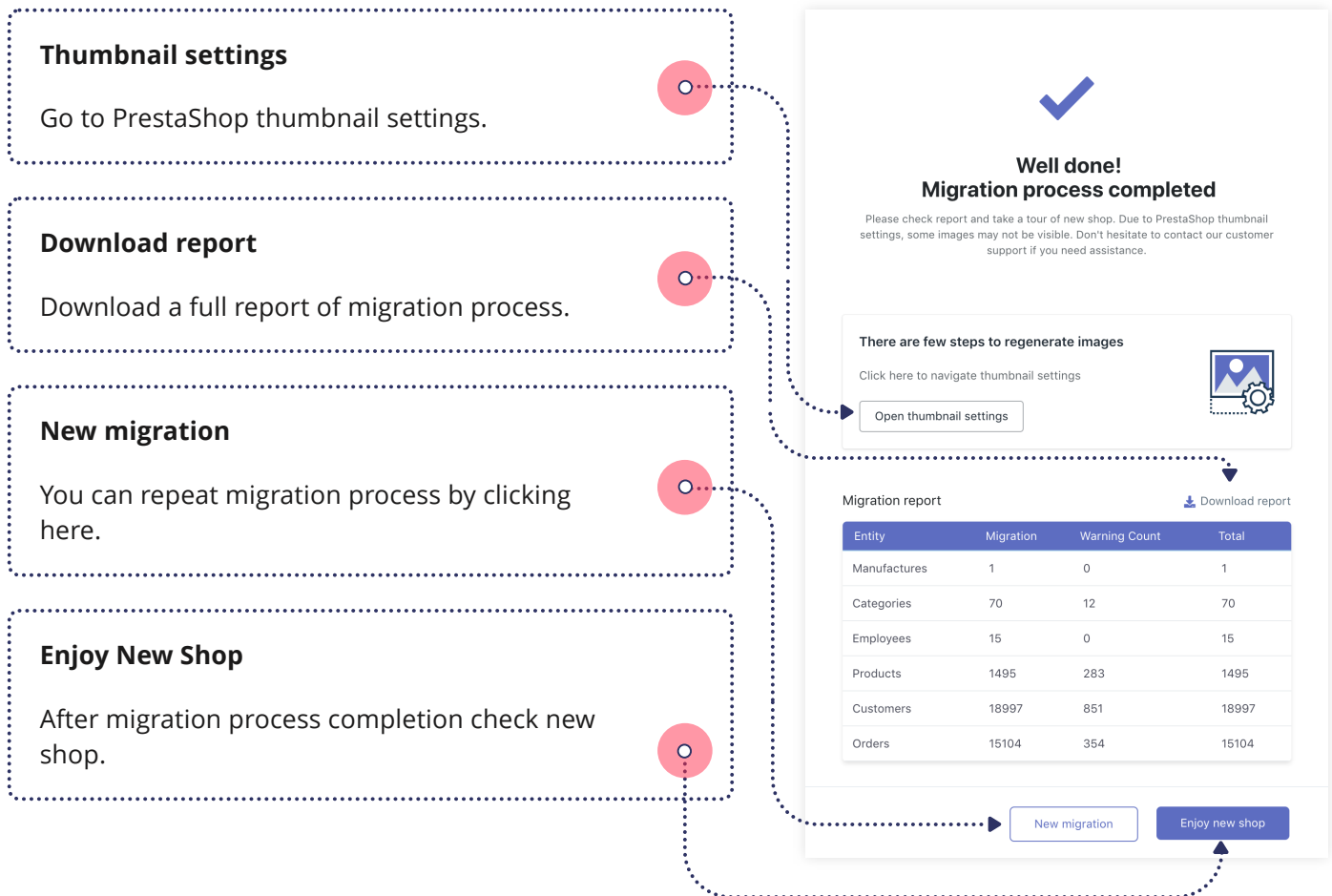



Support

4



360° tech support



Professional care



Customer service



Hotfixing & Troubleshooting

Please drop us a message at: [PrestaShop Addons](#)
We are striving to get your questions answered within 24 hours.

Wish to upgrade shop by experts, lean back and trust us!

Migrating from your current PrestaShop version to PrestaShop 1.7.x is a challenging process. The best and most simple way to make this upgrade will be hiring highly qualified specialists. You can be sure that your PrestaShop e-shop will be in good hands and migration will be handled without errors and data loss.

Specialized Services

- Custom module development
- Professional support service and individual assistance
- Secure, safe and easy migrations from other e-commerce platforms.
- PrestaShop version upgrade to the versions 1.6.x and 1.7.x from PrestaShop stores 1.2, 1.3, 1.4, 1.5, 1.6 and 1.7
- All-in-one Migration and upgrading your shop to Prestashop
- Hotfixing & Troubleshooting
- Installations, setup & maintenance for PrestaShop
- Moving upgraded shop to main domain (if customer installed new shop to the subdomain or another domain)
- Theme Development & Customization
- 3rd Party Integrations

Addons page: https://addons.prestashop.com/en/202_migrationpro

Module Partner page: <https://www.prestashop.com/en/experts/module-creators/migrationpro>